

www.fvqi.org

June 2014

Inside this issue:

From the President

I can hardly believe it was just about a year ago that I was writing my first President's note. I thought that would be the most grueling part of the job, but as it turned out, no part of being President was grueling. I enjoyed the whole year. I'd like to thank everyone on the board for all of their hard work and dedication to the guild. It was a pleasure working with everyone. I wish the incoming board the best of luck. I know we are turning over our duties to a wonderful group of women that will work well together and lead our guild well.

I unfortunately will not be able to attend this month's meeting. For this reason, we will postpone our discussion of the By Laws until the July meeting. I apologize for the inconvenience, but do not want to pass the revising of them onto the new board. I will email the revisions that were discussed at May's general membership meeting within the next week or two. Please take a moment to look at them and bring any questions or comments to our July general membership meeting.

For my last recipe, I decided to leave you with something sweet. A pie that is easy to make and right in season. It was a huge hit at a party I brought it to. If you like ricotta cheese pies, I suggest using 4 ounces of cream cheese and 4 ounces of ricotta. This will change the texture of the dessert and lighten it a bit. Either way you make it, it will be a crowd pleaser. Enjoy!

Chris

Message from the President	1
This Month's Meeting	3
Future Programs	3
Upcoming Workshops	3
Quilt Show 2014	4
Fall Getaway Retreat	8
Spring Retreat	8
Membership News	8
ABC Quilts	10
Community Service	10
Quilt Challenge	11
Neo-Natal	11
Mystery Night	11
Friendship Block	12
Guest Policy	16
Sunshine	16
Member Classifieds	17
Quilt Shows & Events	18
Officer Directory	19

Snippets

- ◆ Meetings begins at 6:45pm
- ◆ FVQI Board meetings are scheduled for the first Wednesday of every month and are open to all members
- ◆ Show and Tell; Neonatal Quilts
- ◆ Library items; Challenge Quilts
- ◆ Friendship Blocks Drawing

Strawberry Rhubarb Cheese Pie

9 inch Pie

By Chris Snieckus

1 9" Pie Crust, unbaked

3/4 cup Fresh Strawberries, washed and hulled, cut into 1/2" cubes
3/4 cup Fresh Rhubarb, washed, cut into 1/2" cubes
1/4 cup Sugar
1 tbsp Corn Starch
8 oz pkg Cream Cheese
1/2 cup Sugar
1/2 tsp Salt
2 Eggs
1/2 cup Milk
1/2 tsp Vanilla

- Preheat oven to 425 degrees (you will lower the temp. after the first 10 of baking).
- In a medium saucepan, combine cubed strawberries and rhubarb. Toss with the sugar and cornstarch. Heat on low for about 4 to 5 minutes, until bubbly and thick. Remove from heat.
- In a medium size mixing bowl, beat cream cheese, sugar, and salt with an electric mixer until smooth. Add eggs and beat again until well incorporated. Add milk and vanilla and beat thoroughly.
- Spread fruit mixture evenly onto the bottom of unbaked pie crust. Pour cheese mixture on top and bake at 425 degrees for 10 minutes. Lower temperature to 350 and continue baking for 25 to 30 minutes, until pie seems solid and cooked through.
- Cool completely before serving. Store in the refrigerator.

This Month's Meeting

Wednesday, June 18, 2014, 6:45 pm

Eno Hall, Hopmeadow Street, Simsbury

Social and Quilt Challenge -

We are serving appetizer-type snacks, desserts and beverages. Many of you have already volunteered to bring something. If you haven't yet signed up or can't remember what you signed up for, please surprise us with some delicious treat or beverage. Another option would be to bring paper plates or plastic silverware. We probably won't need them for this meeting but we can save them for future use.

Mega Book Give Away

The Guild Library Committee is sponsoring a mega book giveaway at the June Social meeting. We have received several gifts over the past year and, after selecting some for the library, the rest will be made available for the taking. Donations will be happily accepted so that we may purchase new books for the library collection. Please feel free to take what you like but remember that the only way to get **new, cool updated books** is by leaving a donation and suggestions on items to purchase. Thank very much from Anne, Lois, and Sharon.

Future Programs

July 16 - Service Meeting, SAQA Traveling Trunk Show - Display of 50 to 100 small quilts (You won't want to miss this!)

August 20 - Trip to the Quilted Ewe in Winsted, CT for shopping discounts and demo on needle felting.

September 17 - Judy Damon - Lecture: "Color Stories for Scrap Quilts"

October 15 - Karen Eckmeier - Lecture: 'Still Makin Waves'

November 19 - Marie Bostwick - Lecture: When the going gets tough the tough turn to quilting

Upcoming Workshops

September 18 - Workshop with Judy Damon Called 'Inspinity Wallhanging: Spotlight on Scraps'

October 16 - Workshop with Karen Eckmeier called Random Roses



Quilt Show

QUILT SHOW 2104 *"Rags to Riches"*



Raffle Baskets / Bags

If you have a contribution for a raffle basket, please bring it to the monthly guild meeting. If you need help filling your basket, let us know!

Quilt Registration

Quilt Registration forms are now ready! You should have received one from Sandi Kingsley via email. You can complete this and email it back to Sandi along with a photo of your quilt. You can also print one from the website and submit it manually. Your quilt top must be completed to register your quilt.

You are allowed to enter as many quilts as you like though you will be asked to prioritize your entries, in the event we cannot fit them all.

Raffle Quilt Tickets



Tickets for our raffle quilt will be distributed at the May meeting. Get your tickets early and sell them to family and friends (or keep them for yourself!). All guild members will be required to take/sell at least 20 tickets. Peg Thomsen will keep track of tickets out and money returned.

We are still looking for volunteers to travel with the quilt to other sites for selling tickets. This could be other guilds, shops or events. We have a quilt stand to help display the quilt. Grab a friend and help your guild in this small way. Contact Lisa Salvatore to sign up. 860-651-6225.

Set-Up & Take-Down Chairperson Needed

Since Elke Mayer has moved to Malaysia, we are in need of a new chairperson of the Set-Up /Take-Down committee. Anyone who has worked on setting up the show knows that this job comes with the full support of the guild behind you. We are all there to help set-up AND take down the show. Demers Co. is there to assemble the poles/curtains and then dismantle them later. The chairperson really just needs to direct everyone to their jobs. Contact Lisa Salvatore if you are interested in helping.

Quilt Show...continued

***Farmington Valley
Quilt Show 2014***

Sat, Nov 1, 10 -5

Sun, Nov 2, 10 -4

University of Hartford

Yard Signs

Would you share your yard with a sign promoting the quilt show? We are looking for volunteers to display a sign during the last two weeks of October. If your house is ideally located for publicizing our show and your town will permit displaying a small sign, please let us know.

Quilt Show...continued

2014 Quilt Show Volunteers:

We are now signing up volunteers to work at our 2014 Quilt Show. The show dates are:

Set Up: Evening of October 31; Show: November 1 and 2; Take Down: November 2.

Please put the Show on your calendar now!!

Sign-ups will occur at our monthly meetings. We ask you to commit to one or two 2 hour shifts and, if possible either Friday night set-up or Sunday afternoon take-down. If you have a preferred task, note it on the sign up sheet; if you need a sitting job, note that; if you would rather not handle money, note that; if the two hour shift is too long for you, team up with a friend, etc. The show time flies by and it is wonderful to spend the time surrounded by the beautiful quilts and dedicated quilters.

The tasks associated with each type of volunteer assignment are listed below:

- Assistant Volunteer Coordinator: (1 person) Share duties with Volunteer Manager such as signing up volunteers, making assignments, reminding volunteers, coordinating work at the show. This is a great way to get to know FVQ members.
- Intake: (5 men and 8 women) Transport quilts from site where they have been collected and distribute to the assigned rows at the show site.
- Friday night set up: (25 men and 25 women) The Set-Up Manager will communicate assignments and arrival times to those who volunteered for Friday night. They will include pinning or hanging quilts for display, help setting up baskets, assisting vendors if needed, handling signs, and other set up tasks.
- Admissions (2 persons per 2 hour shift): Collect entry fee (\$10), stamp hand, give out program, answer questions.
- Quilt Raffle Tickets (2 persons per 2 hour shift): Sell tickets for the raffle quilt.
- Basket Raffle Tickets (2 to 3 persons per 2 hour shift): Sell raffle tickets for the baskets. Record the range of tickets sold by buyer name, for use in identifying basket winners. (This is a legal requirement.)
- Door Guard (2 persons per 2 hour shift): Stand near the entrances to the show hall. Check the hands of those entering for stamp. Give directions and answer questions.
- Vendor Support (1 person per 2 hour shift): Provide relief to vendors who need breaks or assistance. Also act as back-up for those handling the Rovers/White glove assignment.
- Rovers/White Glove (1 to 2 persons per 2 hour shift): Provide relief to volunteers who need breaks or assistance. Fill in for volunteers who don't arrive for slot or need to leave early. Assist attendees who want to see backs of quilts wearing white gloves, or show attendees where to find white gloves for their own use.
- Sunday night take down (15 persons). The Take Down manager will communicate assignments to all who volunteered and the time at which they should report for duty. Be sure you are there by your assigned time to ensure smooth and timely take down of quilts and their return to the owners.
- Food: (1 to 2 persons) Food is not available on site. Food manager will need assistance in ordering or picking up take out food for volunteers on Friday night and at lunch times.

If you have any questions or would like to sign-up at a time other than the guild meeting, please contact Meg Lines at 860 242-1850 or malines7@comcast.net.

Quilt Show...continued

FVQI 2014 Quilt Show Challenge

“Welcome to the World”

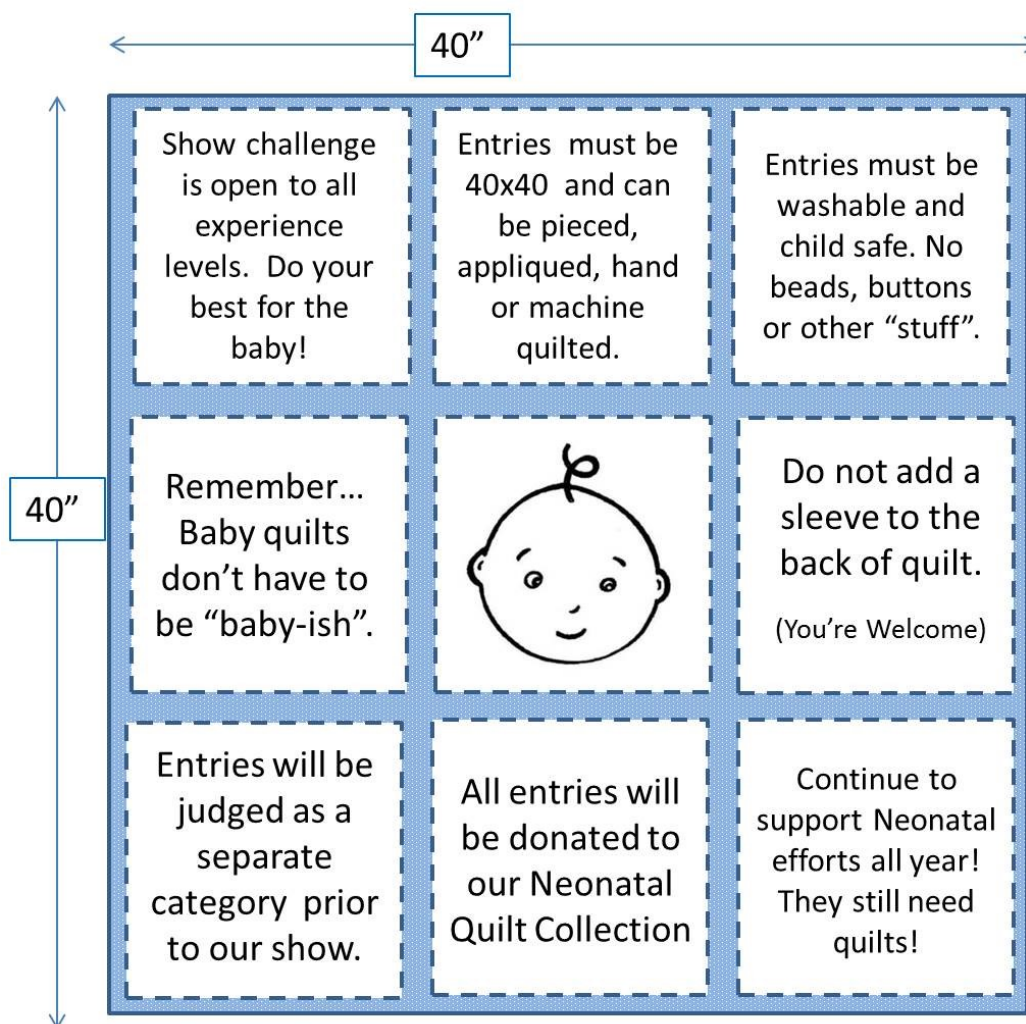

See Phyllis Small and Robin Schofield with questions.

Fall Getaway Retreat

Nothing to report.

Spring Retreat

Mark your calendars....Thursday, March 11 - Sunday, March 14, 2015.

Membership News

From Our 1st Vice President:

Dues Renewal

Dues will not be collected at the June meeting. I am sorry for the inconvenience. You can pay dues at the July meeting, and you are also welcome to mail your \$25 check at any time (payable to FVQI) to: Farmington Valley Quilter's Guild, P.O. Box 172, Weatogue, CT 06089.

Thanks and A Welcome

I want to thank you, members of FVQI, for making my year as 1st VP such an enjoyable one. I will miss meeting everyone at the Hospitality table, and getting to gradually match many faces to the names on my Membership list! Introducing the Show and Tell quilts each month was like narrating a fashion show of fiber art; it was a real privilege, and loads of fun. Getting to know the other officers at the Board meetings, addressing the Guild's concerns and sharing many laughs along the way, was a wonderful and enriching part of these past months for me. All told, this office has been an absolute pleasure.

I especially extend thanks to Chris Snieckus for introducing the details of the job and for her patience with my learning curve; and thanks to Chris, Anne Dodge, and Peggy Thomsen for generously filling in for me efficiently and without hesitation at the meetings I could not attend.

Congratulations and very best wishes to Barb Heagney, our incoming 1st VP. I invite you to join me in welcoming her as she begins her term of office at the July meeting.

With warmest regards,

Maureen Egan

Raffle Gifts

Heartfelt thanks to the members who have recently donated items, or money to purchase gifts, for the raffle that is held at the end of each meeting.

If you would like to contribute something, please drop it off at the sign-in table at any meeting. These are a few items that would be very welcome:

- Quilt shop quality fabric, fat quarter or otherwise
- A notion, tool, thread, or pattern
- A book, new or gently used
- A dollar or two

Membership News...continued

Member Show & Tell

At the May meeting the following members participated in Show & Tell:

Linnea Amodio, Lola Bea Diaper Bag
 Chris Carmon, Road to the Beach
 Tina Davies, A Quilt for a Friend
 Bonnie Llopis, Celebrate Plan B
 Sally Sargent Markey, Quilt Retreat quilt tops
 Elke Mayer, Sashiko/Irish Chain, Sommerwind
 Judy Prohaska, Quilt for Ann's Birthday
 Anne Sahwabik, Waterfall
 Phyllis Small, Peony, *Minimal Quilting* (book)
 Peggy Thomsen, May Mystery
 Jean Williams, Baby Quilts, Hexagon Table Topper

Pictures can be seen in the Photo Gallery on the Guild web site, www.fvqi.org.

Thanks and congratulations to all!

Birthday's:



June

06/03 - Pat Engelhardt
 06/13 - Betsy Henebry
 06/16 - Mary Skwar
 06/16 - Sue Vogt
 06/19 - Lynn Emery
 06/23 - Joanie Cover
 06/23 - Barbara Heagney
 06/26 - Laurie Rio

July

07/02 - Susan Grapkowski
 07/07 - Shelley Cassky
 07/08 - Robin Schofield
 07/11 - Lauren Allison-Fisher
 07/12 - Sharon Lizak
 07/13 - Meg Lines
 07/16 - Marilyn Smeggil
 07/17 - Mary Gridley
 07/18 - Linnea Amodio
 07/18 - Jane Spangler
 07/21 - Donna Flynn
 07/22 - Vivian Lazich
 07/25 - Marguerite Boslaugh
 07/26 - Helga Sobek
 07/27 - Diane Calkin
 07/30 - Minako Oba
 07/31 - Victoria Gabriele
 07/31 - Janet Glynn

ABC Quilts

The ABC, A Better Chance, program is a national, non-profit organization that gives promising minority students an opportunity to receive their high school education at an excellent suburban school. It is a residential program with the students living together in a house in Simsbury. Each student is also sponsored by a local family. Farmington Valley Quilters goal is to provide each boy who enters the program with a new handmade quilt. We started the ABC Quilt Project in 1997 and each year we have presented at least two students with quilts.

The second quilt has the binding stitched on and is ready for hand stitching to the back side. This will be done at the July meeting. If you wish to help with this, bring your hand sewing tools to the July meeting. Thread and needles will be supplied. Thanks to everyone who has helped with this effort.

We look forward to seeing everyone this month.

Donna Dellacamera and Debbie Jacoby

Community Service

Quilt Challenge

June Scrap Quilt Challenge

You've had 10 months to create your Scrap Quilt for the June Challenge. We hope you have enjoyed the challenge this year (and used up some of your stash). This month we will reveal our quilts and vote on our favorites. First prize - Longaberger Market Basket of fat quarters. Thanks to some generous offers by members, additional prizes will be awarded.

The guidelines/rules are as follows:

- Item should be something that you have made between September 2013 and June 2014
- Choose your own pattern
- Can be any size
- Hand or machine quilted
- Item must be a finished project
- Deadline is the June 2014 Guild meeting

If you have any questions, please contact either Linda Walter at LMW810@aol.com or Elaine Reimer at reimereg@gmail.com.

Neo Natal

Thank you for all your donations, and please keep making those neonatal quilts (approximately 40 x 40). We delivered 56 quilts to the NICU in April, and we still have plenty of extra fabric and batting for you to take home from the May guild meeting.

No need to make a label for the back, as we provide Farmington Valley Quilt Guild labels, and sew them on at the service meetings.

If you want to make a special quilt for our Show Challenge, don't turn it in yet, but enter it into the show. There will be ribbons, and the nurses from the NICU will help in the judging. They were thrilled to be asked to participate. After the show in November, all these Challenge Quilts will be donated to the hospital.

Robin Schofield and Phyllis Small

Mystery Night

Thanks to everyone who was able to attend the Mystery Night on May 16th at Sew Inspired. Although it was a small group, it was bit fun! For those that were unable to attend but are interested in the pattern, it can be found on the Moda Back Shop web site.

www.modabakeshop.com/2013/05/boxes-of-colour-quilt

Friendship Block

2013 - 2014

FRIENDSHIP BLOCKS

The tradition is for guild members to participate in making friendship blocks as a way to try a new block, learn a new technique, and finally to have a chance to win the blocks.

You need to complete your block on the due date. Write your name on a piece of paper and attach it to your block(s) so the winner knows who finished the block. Fill out 1 ticket for each block you've completed with your name on it and drop it in the basket provided.

We're going to try some new things.

The winner will win the blocks and 1 yard of coordinating fabric.

If you bring in at least three (3) blocks, you'll get 1 extra chance to win.

Have Fun!!!

Friendship Block 1.....Strata Quilt	Due: September 2013
Friendship Block 2Fast Bow Tie	Due: November 2013
Friendship Block 3..... Salvage Block	Due: MARCH 2014
Friendship Block 4..... Spirited Ladies	Due: May 2014

Questions? Contact: Diane (Popko) Francini
popinct@comcast.net
(860) 223-7084 Home

STRATA QUILT

Fabric Selection: Select quilt shop quality 100% cotton fabric. They make the best quilts. Feel free to use up your scraps, any color goes!!

Long & Narrow Block: 3" x 60"

Let's make a Strata Quilt! Cut strips 1-1/2" wide from interesting fabrics in your stash. Sew the ends together so you have 60" lengths. Then sew 3 of these strip together to make a block about 3" x 60."

Helpful tip: After sewing a long seam, press **before** opening. This "sets the" and makes it easy to keep the seam straight when you press it open. get a little curvy.

Enter your name in the drawing once for each 3" block entered. You'll earn an extra ticket if you make three or more blocks.

Thanks to Empire's Block of the Month website for this great idea.



FAST BOW TIE

This block takes less than 10 minutes to make, so you might want to make a bunch. Win the blocks, and your quilt is almost done!

Choose 2 fabrics: White (or ivory, ecru, parchment...) for the background fabric and a colorful Kaffe Fasset print for the bow.

CUT two 3-1/2" squares from each fabric. CUT two 2" square from the print.



Cut 2 background
3-1/2"



Cut 2 print
3-1/2"



Cut 2 print
2"



Sew the small print square to the background square from one corner to the opposite on the diagonal. Cut away excess fabric 1/4" from stitching line.



Fold out triangle and press.



Sew each half of the block to complete the Bow Tie.

SALVAGE BLOCK

Fabric Selection: Select quilt shop quality 100% cotton fabrics and cut off the salvage. You want to cut you salvage between 1" to 1 ½" wide.

Start with a very light interfacing block cut to 6-1/2" square. If you don't have the interfacing, you could use a light cotton fabric.

Start in the corner. Lay down your 1st strip, right side up.

Your 2nd strip, right side up, will go over your 1st strip. Leave a bit of fabric color showing to add interest. Make sure you have about a ¼" overlapping the 1st strip.

Sew very close to the salvage edge of each new piece added. If your salvage has a shaggy edge, sew on the inside of the shaggy edge.

Flip over the 2nd strip and trim to ¼" seam if needed. Flip it back. Continue until your block is covered corner to corner. Trim your block to a 6-1/2" square.



RAG DOLL OR SPIRITED (LIBERATED) LADIES

This truly is a "free spirit" block. The instructions are from Material Obsession by Kathy Doughty and Sara Fielke. Once you're comfortable with the suggested blocks, you can decide what you want to do differently for other blocks. The dolls need not be the same.

Block Size: I've chosen to make this block size about 6-1/2" X 8" finished (7" X 8-1/2" unfinished). The winner of the blocks can always size the blocks and add other borders if needed or desired.

Fabrics: As always, it's best to use 100% quilt quality cotton. So this is truly an opportunity to use up more of your scraps. The background fabric should be white or white on white. Have fun with the clothing. Although the pattern shows the dress as one piece, you can always adlib. OR change the dress into pants by modifying the pattern. Then there's hats, shoes, necklace, hair, purse, garden toolsEndless possibilities.

Making dolls: Doll Construction:

Stage 1 -
Head

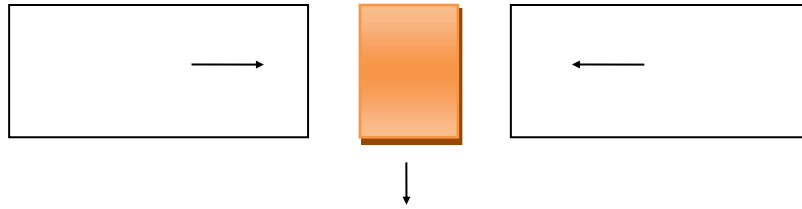

Stage 2 -
Arms/Hands

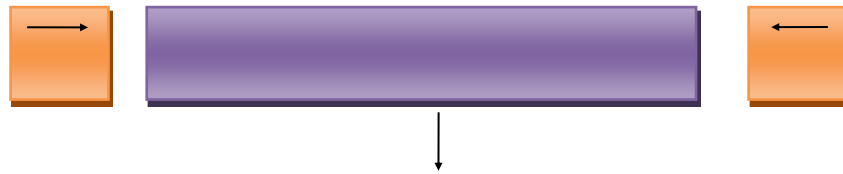

Stage 3 -
Dress

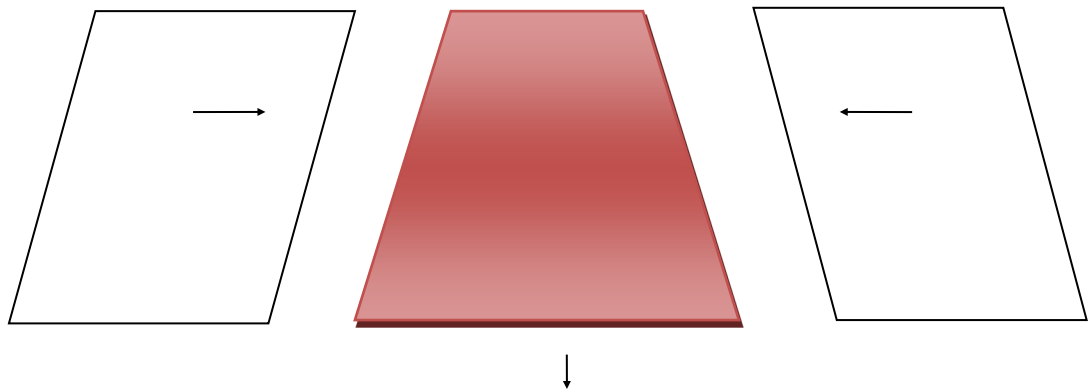

Stage 4 -
Legs

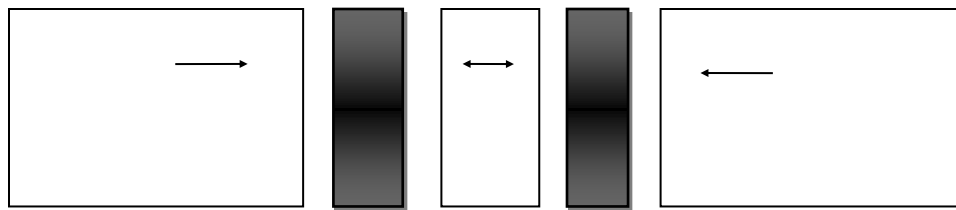

Sewing Dolls:

Stage 1 – the dress: Decide on the width of your dress. Add background fabric to both sides of the side of your dress. Make sure you've left enough fabric for the overall block size (including seam allowance – 7" to 7-1/2" wide). It's fine if the dress is not exactly centered in this piece.

Stage 2 – the arms/hands: sew a 1" x 2" skin tone rectangle to either side of a 1" x 4-1/2" piece of dress fabric and press seams toward the dress fabric. This piece forms your arms and hands. This piece will be trimmed down later.

Stage 3 – For the dolls head, cut skin tone fabric to 1-1/2" square and add background fabric to both sides. Press toward background fabric. Again, make sure you've left enough fabric for the overall block size (including seam allowance – at least 7" to 7-1/2" wide).

Stage 4 – For the legs, piece a strip of skin tone 1" x 3" to background fabric. Check the diagram to see how the legs are pieced. Press the seams toward the legs. Remember, your legs can actually be any color – think tights, pants, etc.

Joining Stages - Before you join your four stages together, consider if you want to add any embellishments that can be added at the seams. Add buttons and bulkier embellishments once your doll is assembled and ironed. You can finger-press the center of each strip and use this to assemble all the stages. Keep in mind that perfection is not a requirement.

Embellishments: Now's the time to get creative. You can add a hat, fringe, and anything else to give your doll her own personality.

Guest Policy

There will be a \$5.00 **Guest Fee** at Guild Meetings with fee speakers and potluck dinners.

Guest who join the guild that evening do not have to pay the guest fee.



Sunshine

If anyone needs a cheer card or a sympathy card . You can contact Anne Baldis - annieb1953@aol.com or Sue Trimble - susanqtrimble@gmail.com or any board member.



Member Classifieds

This is a new feature to the Newsletter. If you would like to advertise a service or are looking to sell or buy something related to quilting/sewing, you can now advertise it here. Your advertisement will be kept in the Newsletter for six months; after which it will be removed unless told otherwise.

Quilts of Valor

Join us in making Quilts of Valor for service people touched by war, Avon Congregational Church, 6 West Main (Rt 44), Apr 18, May 9 & 23, Jun 13 27, Jul 11 & 25, Aug 8 & 22, Sep 12 & 26, Oct 10 & 17, Nov 14 & 21, Dec 12 & 19; 6 PM - 9 PM. Coaches, Rookies, and all in between are welcome.

8/13

Services: Get all those quilt tops finished up so you can work on something new. Debbie De'Angelo from The Quilted Basket can get them quilted for you in just a few weeks. You can drop them off to me at Sew Inspired any Tuesday or Thursday; at any of the guild meetings; or come to my studio. Remember, I carry all the gorgeous SewBatik WideBacks and Quilters Dream Battings.

Call 860-621-5596 or quiltedbasket@gmail.com for more info.

05/14

For Sale: Walking Foot; Singer, slant shank, never used. \$15 Contact Karen Hines 860.651.3640.

02/14

Workshop Opportunity with Apple Valley Quilters: On Friday, July 11, certified Judy Niemeyer instructor Jack Kunkel will be doing a workshop on your choice of 2 of Judy's patterns. Sand Devils is a 54" x 70" quilt, or Witches Brew bed/table runner, finishes to 23" x 117" (long enough to fit up to a king size bed). You can view either pattern on Jackie's website at cvquiltworks.com. Fee is \$35.00. Contact Donna Nicklis to sign up or for more info at nicklisd@yahoo.com.

04/14

Viewing: Sally Sargent Markey has paintings at Starbucks in Simsbury for the month of June.

06/16

Quilt Shows & Events

For a national and international calendar of quilt events go to the Studio Art Quilt Associates, Inc. website: www.saga.com

June 1 - 30, 2014

Sally Sargent Markey has paintings at Starbucks in Simsbury for the month of June.

June 1 - 30, 2014

Women Against the Grain, An Art Quilt Exhibit
Simsbury Public Library Program
All of those exhibiting are members of Farmington Valley Quilters. Please stop by and view our work.

June 27 - 29, 2014

Vermont Quilt Festival
11 Pearl Street, Essex Junction, VT
Fri-Sat, 9am-6pm
Sun, 9am-3pm
\$12 Admission
www.vqf.org

August 2-3, 2014

Clamshell Quilt Guild—2014 Quilt Show
“Quilts Around Town”
Connecticut College in New London, CT
Admission will be \$8.00 per person, one day entry, or \$12 both Saturday and Sunday.
www.clamshellquiltguild.org/show.html

August 14-17, 2014

World Quilt Show - New England XII
The Radisson Center of New Hampshire
Manchester, NH
www.worldquilt.com

September 13-14, 2014

Bennington Quiltfest
Mount Anthony Union Middle School
747 East Road, Bennington, VT
Sat, 9am-5pm
Sun, 9am-4pm
www.benningtonquiltfest.com

2013—2014 FVQI Board Members

President	Chris Snieckus
First Vice President	Maureen Eagan
Second Vice President	Sue Gauvain
	Sally Sargent Markey
	Elaine Reimer
Secretary	Robin Schofield
Treasurer	Lori Yount
Newsletter Editor	Christine Zepp
Quilt Show Chair	Lisa Salvatore

2013—2014 Committees

ABC Quilts	Debbie Jacoby & Donna Dellacamera
Bee Keeper	Jane Hadley
Fabric Swap Box	Sue Elliott
Friendship Blocks	Diane Francini
Hospitality	Anne Dodge & Peggy Thomsen
June Challenge	Elaine Reimer & Linda Walters
Library	Anne Dodge
	Lois Palmer
	Sharon Lizak
Mystery Night	
Neo Natal Quilts	Phyllis Small & Robin Schofield
Retreat—Fall	Meg Lines & Faith Roth
Retreat—Spring	Christine Zepp
Socials	Meg Lines & Faith Roth
Webmaster	Laurie Rio

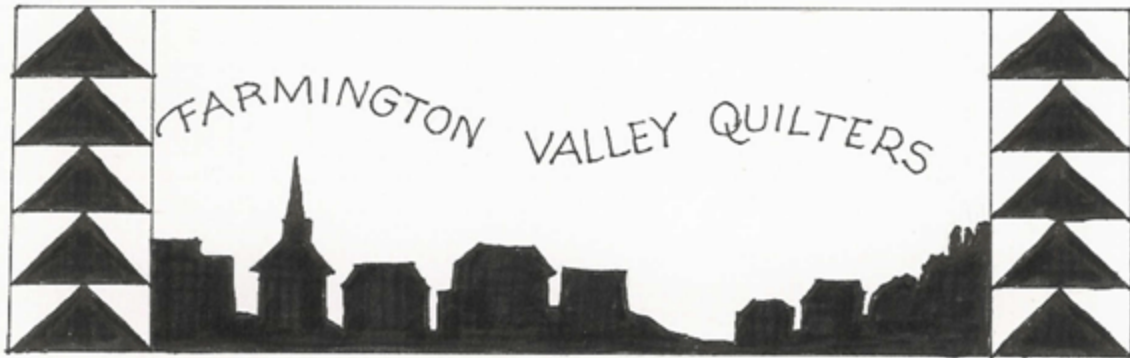

Farmington Valley Quilters, Inc.

P O Box 172

Weatogue, CT 06089

Meetings typically held at

Eno Memorial Hall

Hopmeadow Street

Simsbury, CT

For more information

go to

www.fvqi.org